

ASSEMBLY NOTES:

6

6 REDRAWN IN SOLIDWORKS
REMOVED FROM SCHEDULED DRAWING

1. LOCATE CABLE ENTRANCE TO ALIGN WITH TEETH OF RATCHET.
2. THREAD CABLE END, ITEM 6 THROUGH HOLE IN DRUM SIDE.
SLIDE CABLE CLIP, ITEM 7, ON END OF CABLE AND LOOP CABLE
END BACK THROUGH CLIP A SECOND TIME PRIOR TO TIGHTENING CLIP.
3. TWO SET UP TURNS ON REEL PRIOR TO ASSEMBLY OF BALL STOP, ITEM
AND THIMBLE, ITEM 17
4. ASSEMBLE BALL STOP, ITEM AND CLAMP, ITEM 8, 18 INCHES
FROM END OF CABLE
5. SLIP TWO CABLE CLAMPS, ITEM 7, ON END OF CABLE, APROX. 6 INCHES
FROM END PRIOR TO WRAPPING. WRAP CABLE AROUND THIMBLE, ITEM 17 AND
INSERT CABLE BACK THROUGH CLIPS THEN TIGHTEN. ATTACH ITEM 13

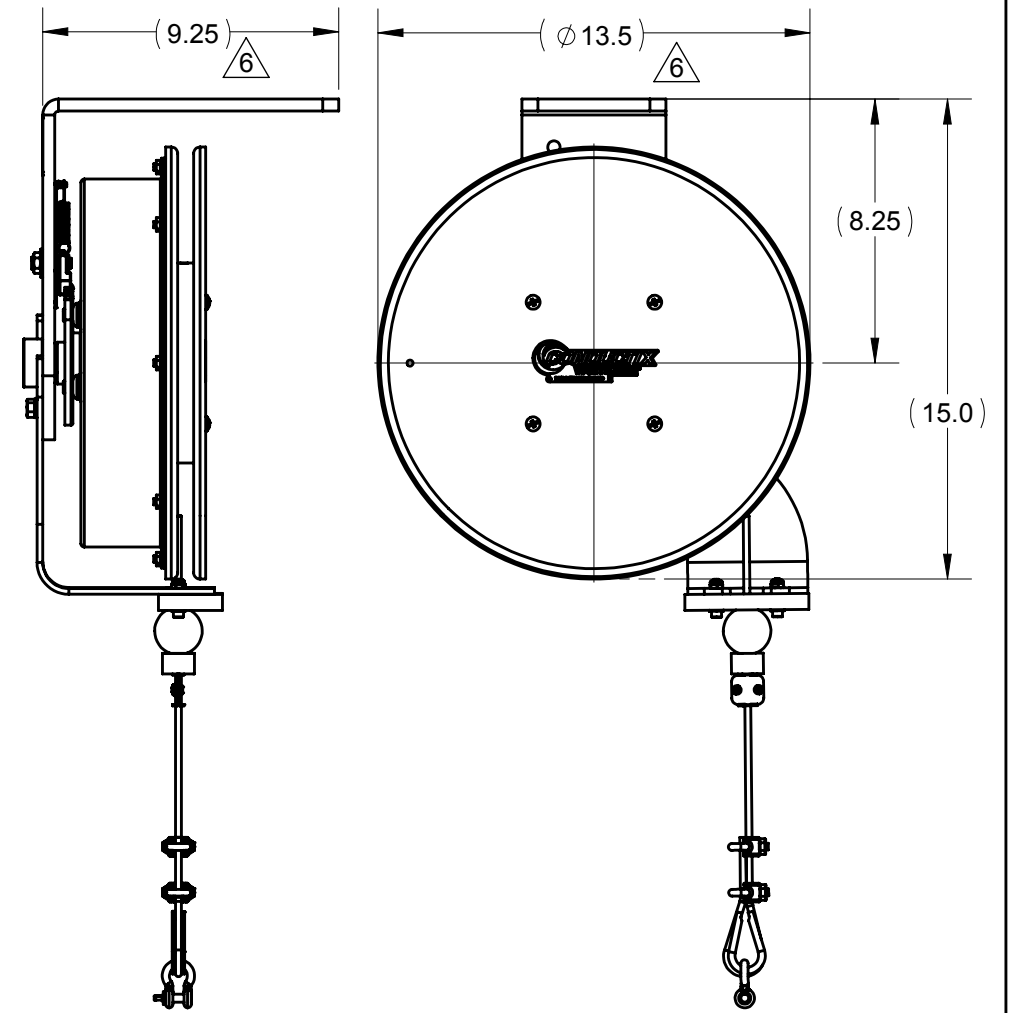

SEE NOTE 1&2

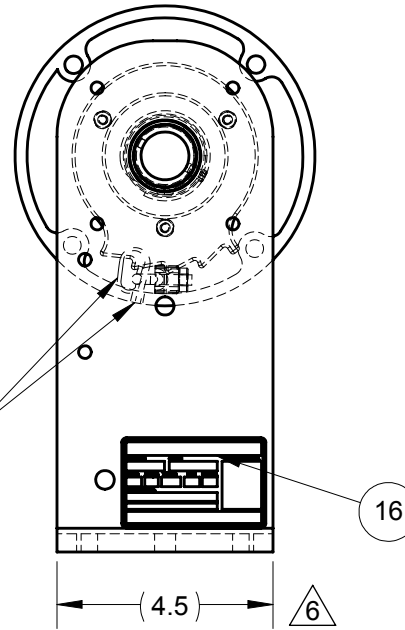

RATCHET/DRUM ORIENTATION

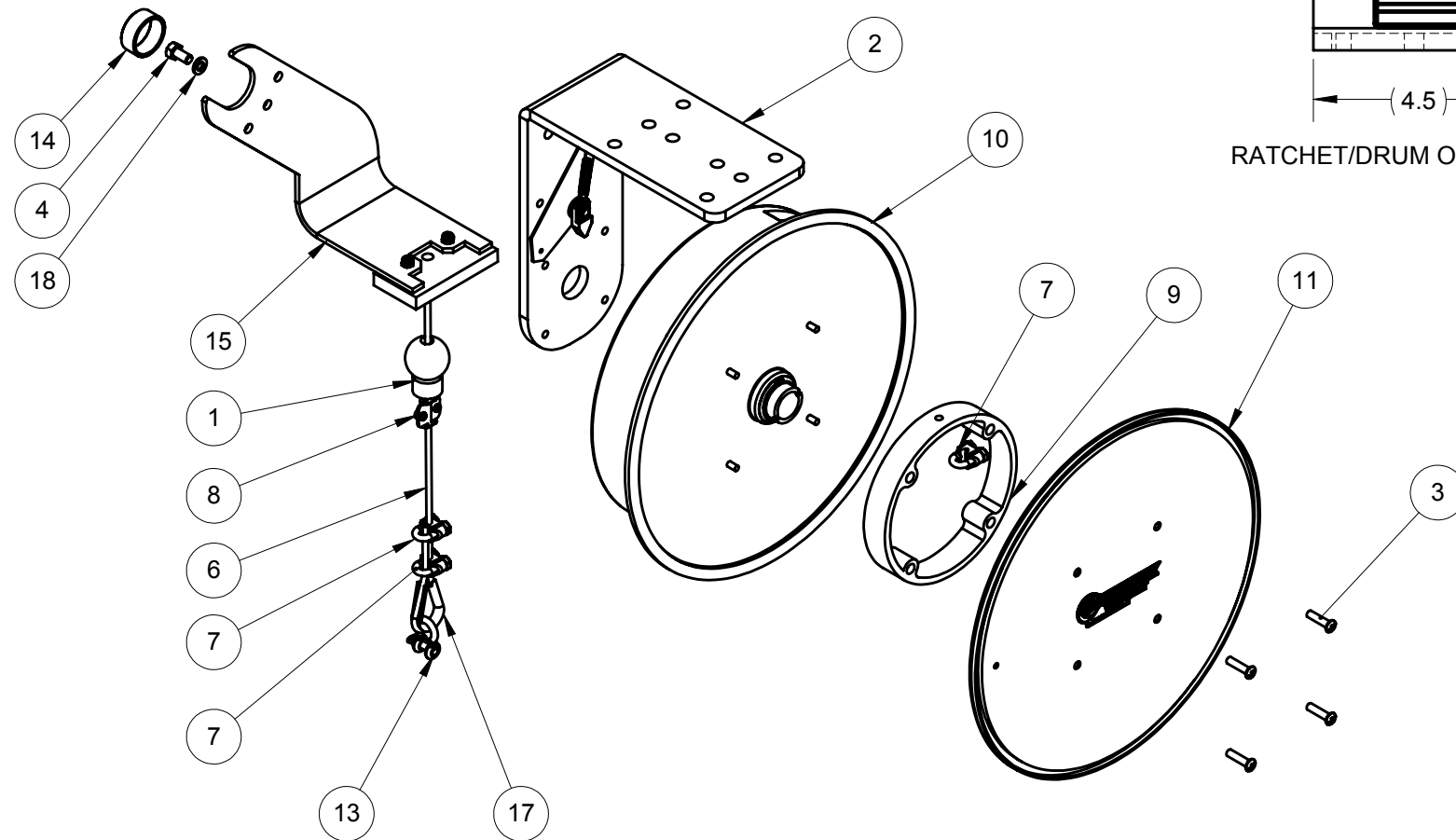

ITEM	MATERIAL NO. 2	DESCRIPTION	QTY.	UNIT
18	XA-10043	WASHER 5/16 LK SPLIT PS	1	PC
17	XA-22952	THIMBLE PS REF TO DRAWING	1	PC
16	XA-34739	STICKER PR SERIAL NUMBER	1	PC
15	XA-PR87-3T	GUIDE ARM SUB ASSY YEL	1	PC
14	XA-PR47-H	SHAFT CPLG SHRT	1	PC
13	XA-09445	SHACKLE 1/4 PIN GALV STL	1	PC
12	XA-35013	PACKING FOAM BOT 1400 PR FORMED	2	PC
11	XA-PR08THW	FLANGE FRONT TORQUE HW REEL SCHED	1	PC
10	XA-PR89PT	SPRING CRTG PARALLEL J TR	1	PC
9	XA-PR99A	DRUM 1.00 THK	1	PC
8	XA-E1325	CLAMP BALL STOP	1	PC
7	XA-22951	CABLE CLAMP PS 6MM REF TO DRAWING 23288	3	PC
6	XA-83098	CABLE 3/16 DIA NYL ST (1/8 DIA W/O NYL)	42	FT
5	XA-35012	BOX CARDBOARD 1400 SERIES	1	PC
4	XA-09522	BOLT 5/16-18 X .63 HEX GR5 PS	1	PC
3	XA-07890	BOLT 1/4-20 X 1.00 10-24 BARREL INT THD	4	PC
2	XA-PR04A-2	BASE ASSY 1400 YEL	1	PC
1	XA-34885	BALL STOP .19-.44 OD CBL (ROUND)	1	PC

STATUS: RELEASED		DESCRIPTION: REEL TR PDJPT 1/8-40 CBL	
ER NO. 68687	UNLESS OTHERWISE SPECIFIED INTERPRET GEOMETRIC TOLERANCING PER ASME Y14.5	PROPRIETARY AND CONFIDENTIAL This drawing and the information shown constitute trade secret and confidential property of Conductix, Inc. It is subject to recall, and is loaned for use only in connection with the authorized manufacture or installation of Conductix, Inc. products, and on the condition that it will be treated as confidential and will not be disclosed, published or reproduced in whole or in part, or permitted to be viewed or used by any other party, without specific written permission. Receipt and use of the drawing and information constitutes acceptance and agreement to the above.	
ER DATE: 07/07/2016	PRIMARY UNITS ARE IN INCH POUND SECONDS SECONDARY UNITS IN MILLIMETERS KILOGRAMS SECONDS TOLERANCES ARE AS FOLLOWS DECIMAL: X.X ± 0.1 IN (2.5 MM) X.XX ± 0.03 IN (0.8 MM) X.XXX ± 0.010 (0.25 MM)		
ER ENGR: S MONSON	ANG. ± 1°	MATERIAL NO. 2: XA-146920104021	
ER APPR: D SAMPSON	FRAC. ± 1/16	REV: 6	
APPR: D SAMPSON	THREAD CLASS: 2 ALL DIMENSIONS GREATER THAN 24.00 INCHES HAVE A TOLERANCE OF ± .063 IN UNLESS OTHERWISE SPECIFIED	SIZE B SCALE: 1:6	WEIGHT(REF): 57.74 LB MATL.



10102 F Street
Omaha, NE 68127
800-521-4888

SHEET 1 OF 1